

PLASMA TORCH & PARTS

SG 55 / AG 60 PLASMA CUTTING TORCH

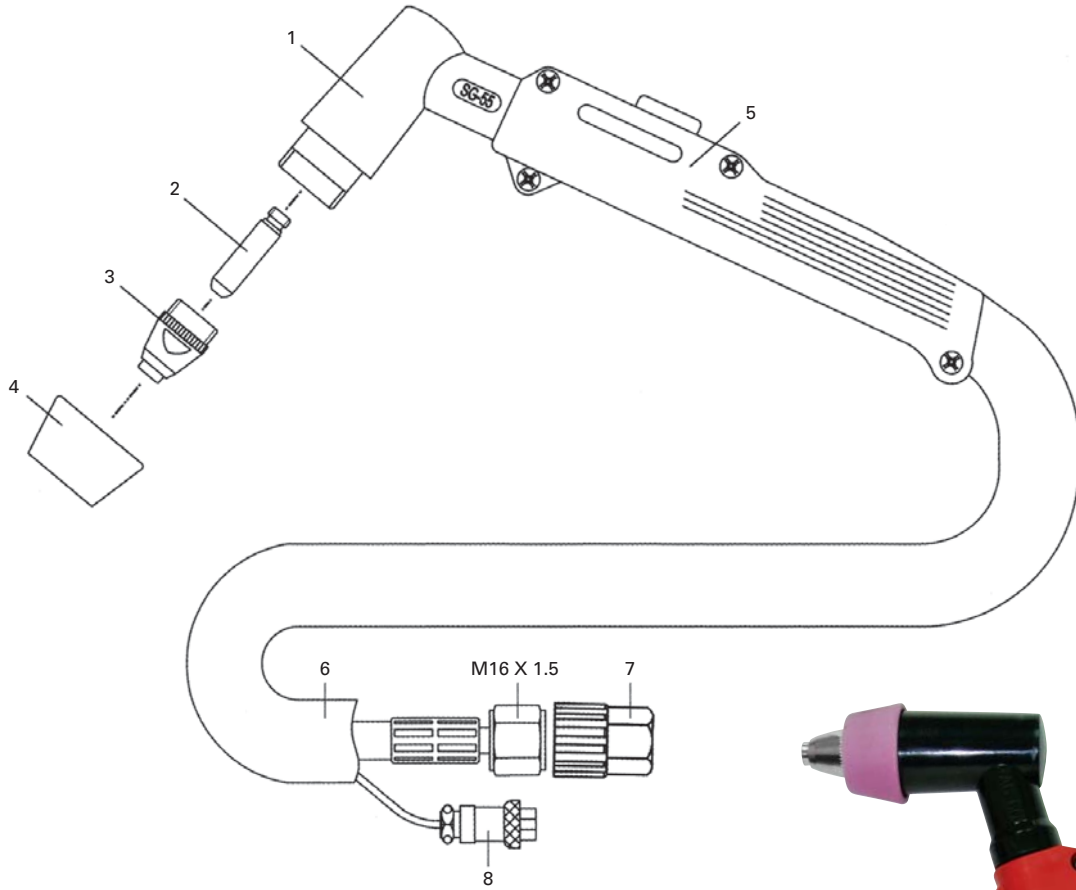

Standard Length: 7.6M | Air Pressure: 4.5 - 5.5 Bar | Duty Cycle 60%: 60 A

No.	Description	No.	Description
	SG 55 / AG 60 Plasma Torch Complete Set 7.6M	5	SG 55 / AG 60 Handle
1	SG 55 / AG 60 Hand Torch Head	6	Cable Assembly
2	SG 55 / AG 60 Air Electrode	7	Nut Cup
3	SG 55 / AG 60 Air Nozzle / Cutting Tip	8	Pana Small 2-Pin
4	SG 55 / AG 60 Shield Cup		

